

Radpol lifting magnets

Permanent Lifting Magnet are compact and self-contained product for lifting and handling steel plates, pipes, beams and cylindrical work pieces of ferromagnetic materials. It contains powerful NdFeB permanent magnet to maintain holding power indefinitely. It is not only convenient in operation with a strong holding force, but also safe and reliable. No electric power is needed, so it can be operated in places where electric power is not available.

Our model for permanent lifting magnet is PML. It lifts, transports and releases the load rapidly with the simple motion of a lever using a single operator. Once activated, a spring-loaded device blocks the manoeuvring lever preventing any accidental deactivation. It features a 3.5:1 safety factor of the recommended load.

Permanent Lifting Magnet are widely used for lifting and hoisting in factories, warehouses, on wharves and at transport facilities.

Features:

- Available in the lifting capacities of 100kg, 300kg, 600kg, 1000kg, 1500kg, 2000kg, 3000kg and 6000kg.
- 3.5 times for safety factor.
- No electrical power required.
- Self-locking safety block prevents accidental deactivation.
- Maintenance Free with zero running costs.

Operation:

- Simply move the lever to the ON position to engage the magnet while lifting materials.
- Safety lock keeps the permanent lifting magnet engaged until you release it.

Warning: Never move the lever to the ON position unless the permanent lifting magnet is placed on an iron or steel object.

Applications:

- Hundreds of lifting and positioning applications.
- Loading or unloading many work pieces including press moulds, plastic moulds, machined parts etc.
- Can be used in multiples with a spreader bar set to lift long lengths or plate

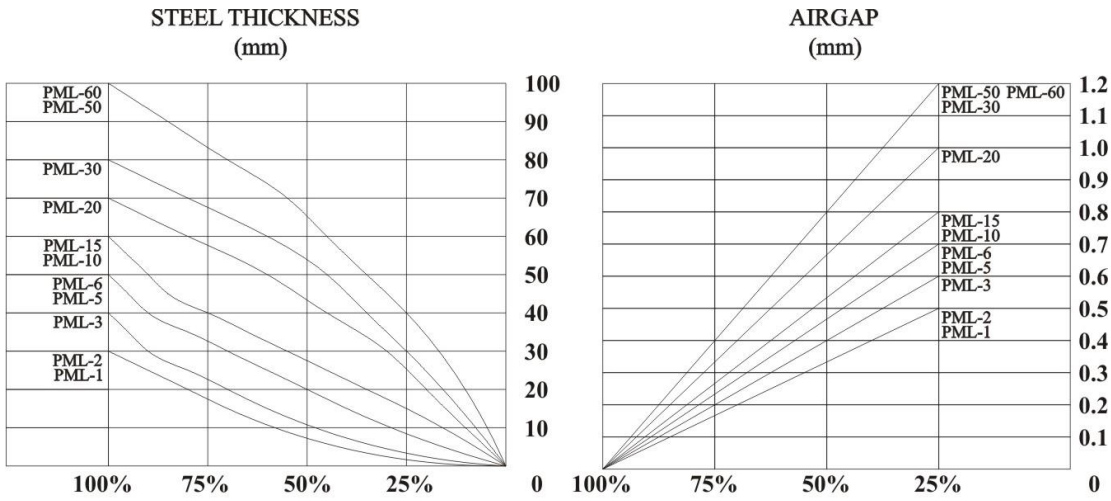

Safety capacity curve

Thickness (mm)	Effective percentage of rated capacity						
	PML-60 PML-50	PML-30	PML-20	PML-15 PML-10	PML-6 PML-5	PML-3	PML-2 PML-1
100	100%	100%	100%	100%	100%	100%	100%
90	85%						
80	70%	80%	80%	90%	90%	90%	100%
70	55%						
60	45%	60%	80%	100%	100%	100%	100%
50	35%	45%	60%	90%	100%	100%	
40	25%	35%	45%	75%	90%	100%	100%
30	-	25%	30%	55%	70%	90%	
20	-	-	20%	35%	50%	70%	80%

Safety Capacity Data for Thickness(Reference)

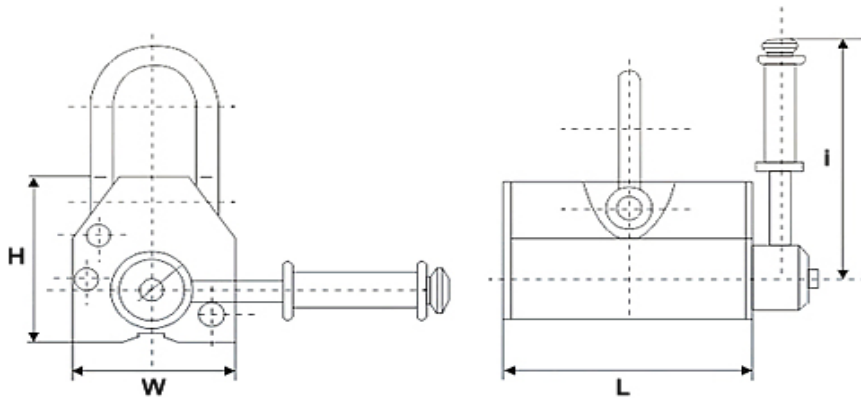

- Range of capacities from 100Kg to 6000Kg with a 3.5:1 safety factor.
- Available in 8 models.

Model	Rated lifting strength (kgf)	Cylindrical lifting strength (kgf)	Max. pull-off strength (kgf)	W	L	H	I	Operation temperature (°C)	Dead weight (kg)
PML-01	100	30	350	62	100	68	185	< 80	3
PML-03	300	100	1050	94	168	96	214		10
PML-06	600	200	2100	125	235	115	230		22
PML-10	1000	300	3500	135	283	140	325		36
PML-15	1500	500	5250	145	364	153	390		66
PML-20	2000	600	7000	156	446	165	455		81
PML-30	3000	1000	10500	216	453	176	520		160
PML-60	6000	2000	21000	255	753	285	810		410